

PLAN INDEX

- Plan 1 Plan of application land (edged red)
- Plan 2 Map showing boundaries of the Civil Parish of Semington (incorporating the application land coloured blue and index of streets within the village)
- Plan 3 Plan produced by the applicants showing the application land with perimeter access points
- Plan 4 Extract from working copy of definitive map of public rights of way
- Plan 5 Application map with DMMO application to add footpaths to the DMS made in April 2016

PLAN 1

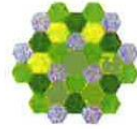

© Crown copyright and database rights 2015 Ordnance Survey 100026316. You are not permitted to copy, sub-license, distribute or sell any of this data to third parties in form.

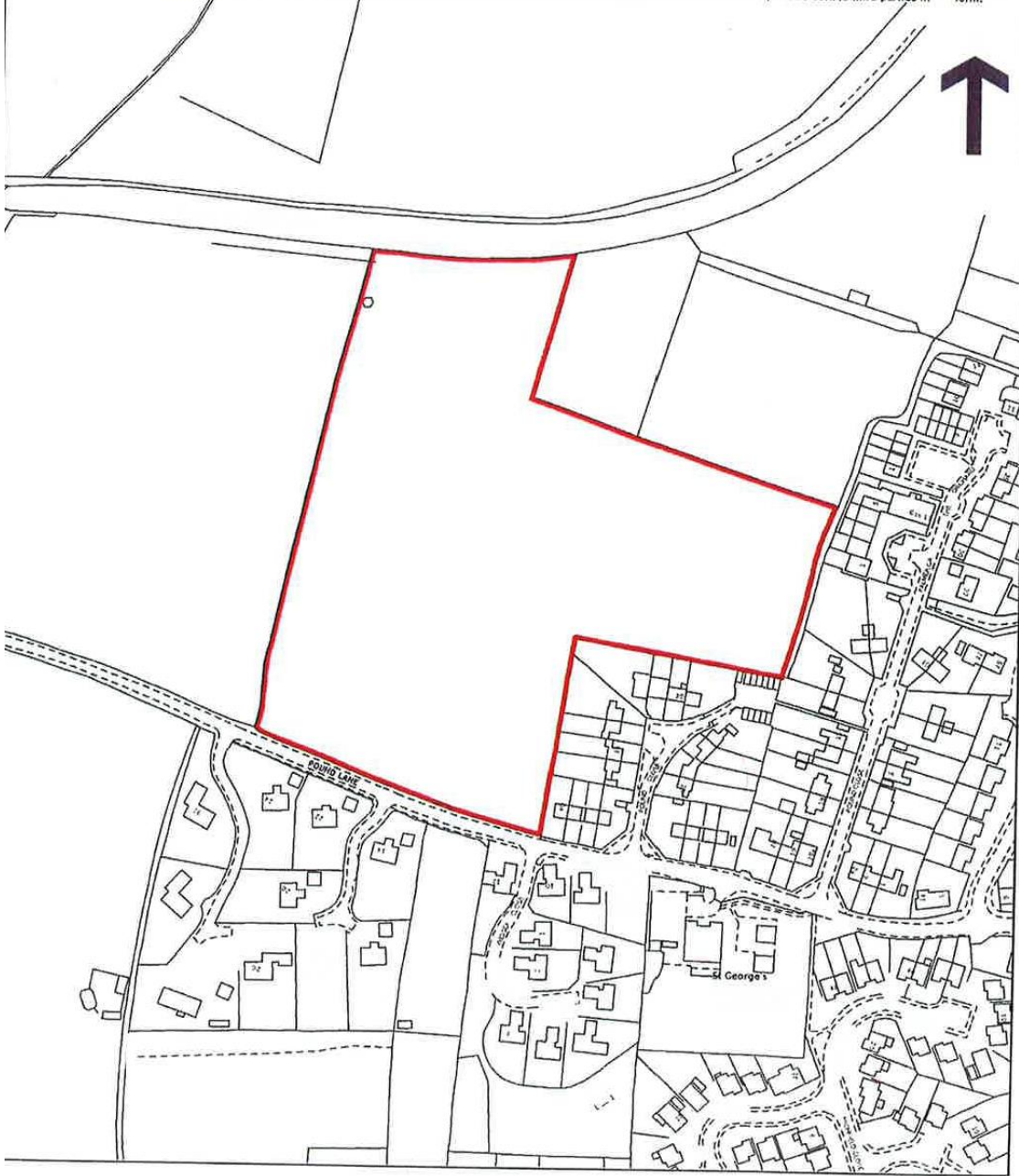

PLAN 2

Semington Town and Village Green
Street Map

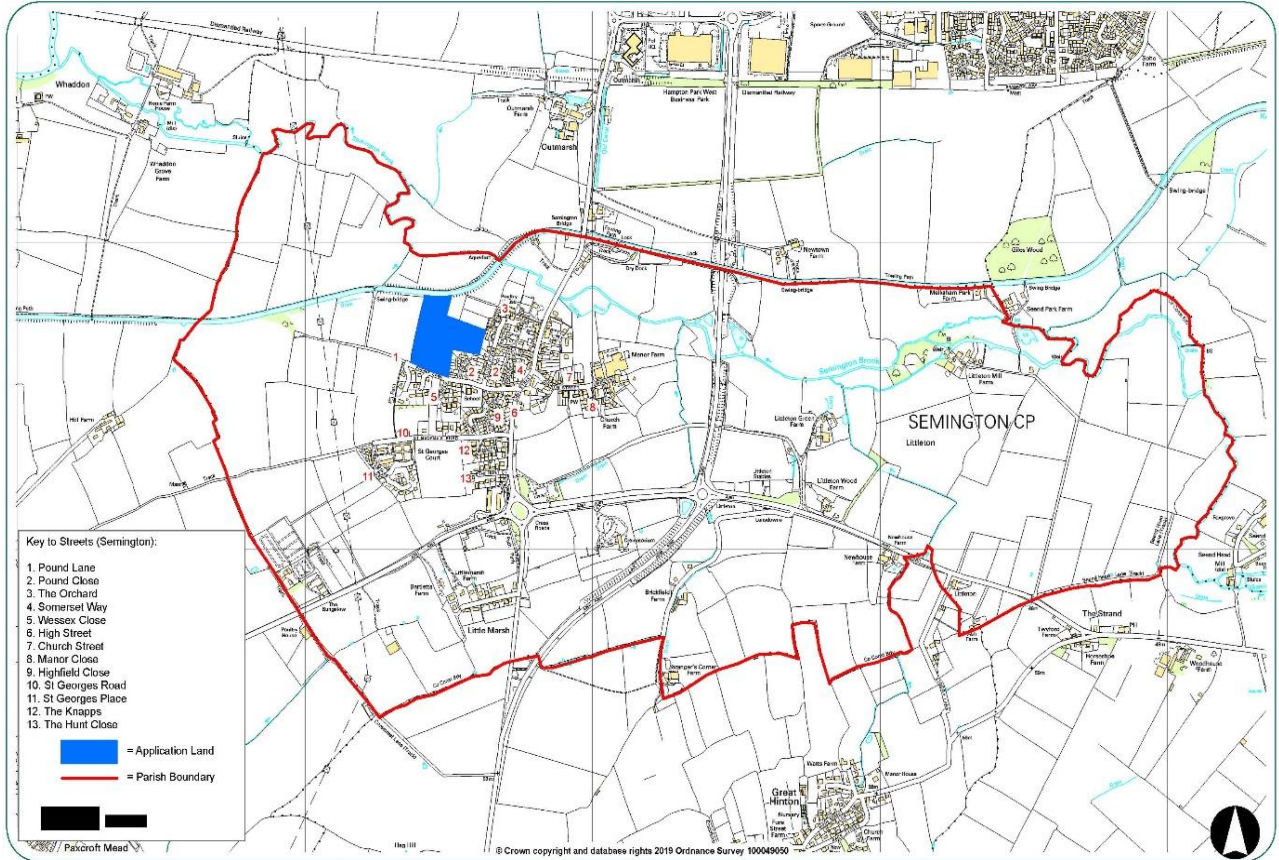

PLAN 3

2. Map showing the Great Lees Field boundary and perimeter access points

Access points to Great Lees Field:

1. the gate on Pound Lane
2. the gap in the western boundary hedge ~20 metres north of Pound Lane
3. the gateway in the western boundary hedge ~90 metres north of Pound Lane
4. stile at the western end of the right of way running along the northern boundary of the field
5. the southern bank of the Kennet & Avon canal
6. stile at the eastern end of the right of way running along the northern boundary of the field
7. back garden gates of numbers 29 to 36 Pound Close

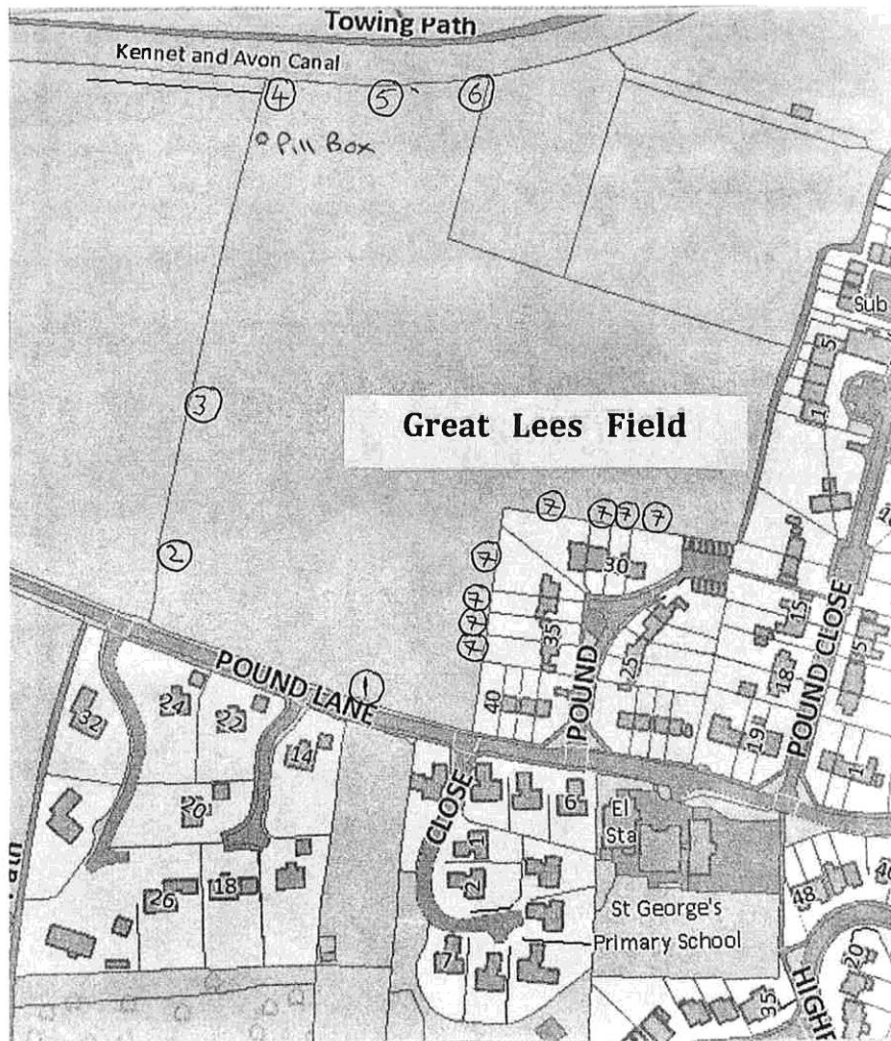

PLAN 4

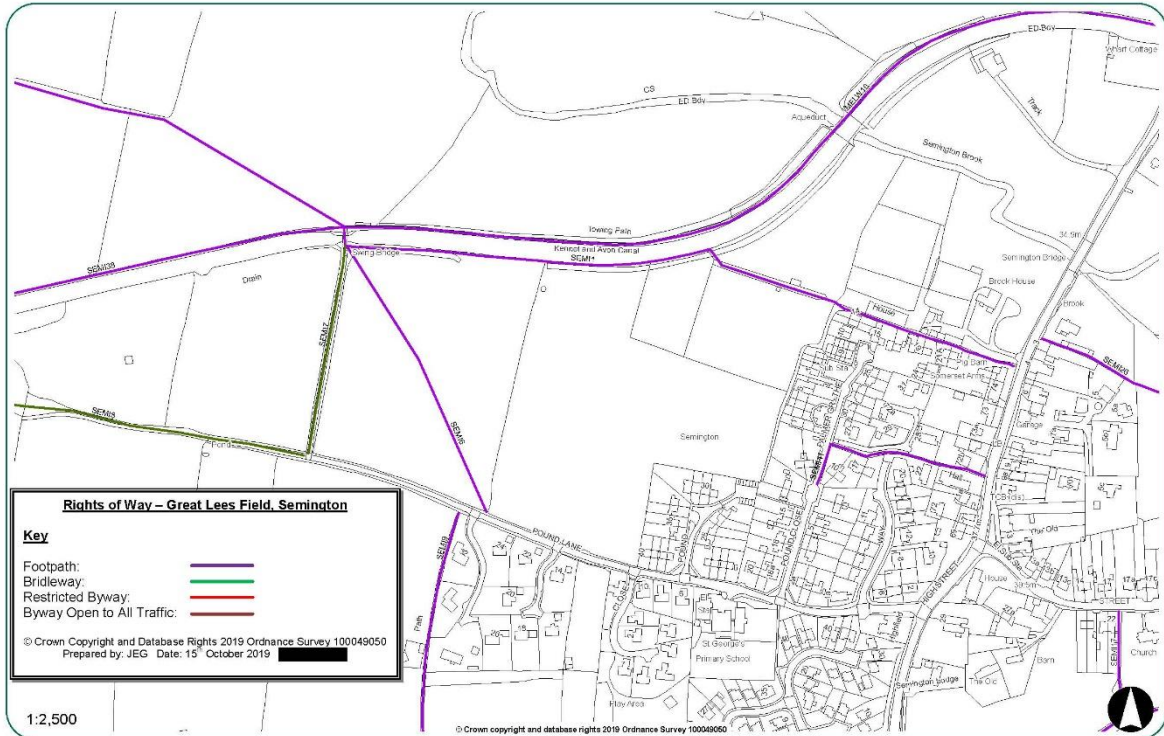

PLAN 5

1.1 Extract from application map:

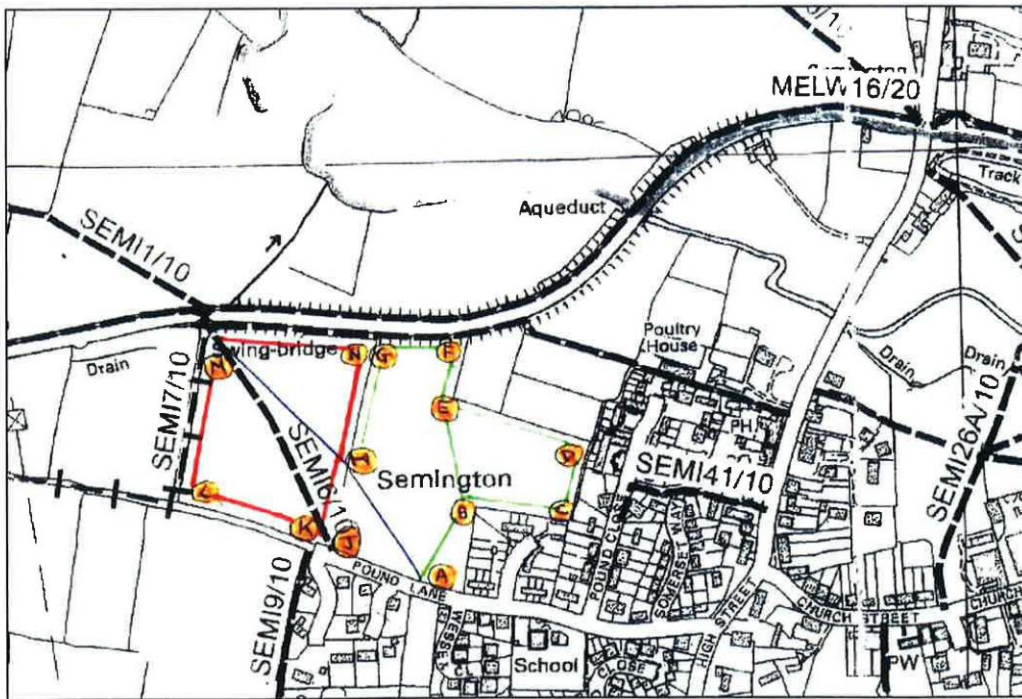

1.2 Routes claimed:

- Red route – K-L-M-N
- Green route – A-B-C-D-E-F-G-H
- Blue route – A-H-M

